

Call: +44 (0)1252 361550



## Bridge Court, Farnham, Surrey, GU10 4QE

An immaculately presented three bedroom end of terrace property within a quiet cul-de-sac on the south side of Farnham. Situated within 400 yards of Weydon School and just 1.5 miles from Farnham train station which offers direct links to London Waterloo in under an hour, the property was built as recently as 2008 by Arcadia Homes. There is a spacious entrance hall which leads to a kitchen/breakfast room to the front of the property, large enough for a table and complete with inbuilt appliances; in addition to a downstairs WC, the ground floor also comprises a 15x15ft living room across the rear of the property with patio doors leading to the south facing garden. To the first floor are three bedrooms and the family bathroom; two of the bedrooms are generous doubles, with the master benefiting from an en-suite shower room.

Price: £375,000

### Overview

- Three Bedrooms
- Two Bathrooms
- Kitchen/Breakfast Room
- South Facing Rear Garden
- Off Road Parking
- 400 Yards to Weydon School
- 1.5 Miles to Train Station
- Constructed in 2008
- EPC Rating C : 77
- Freehold

Call: +44 (0)1252 361550





Call: +44 (0)1252 361550

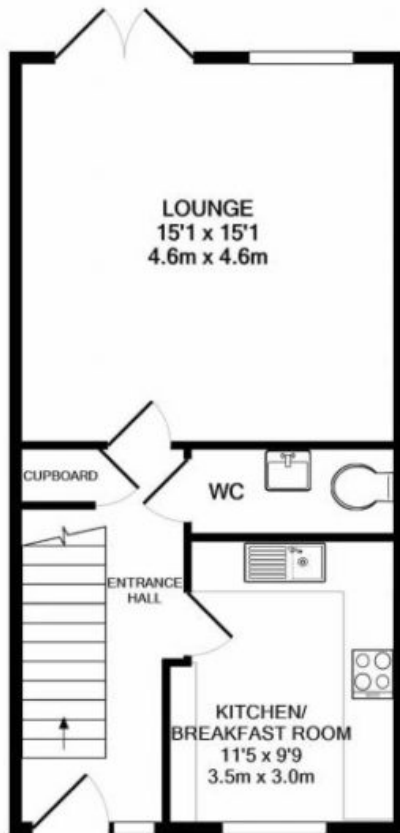

GROUND FLOOR

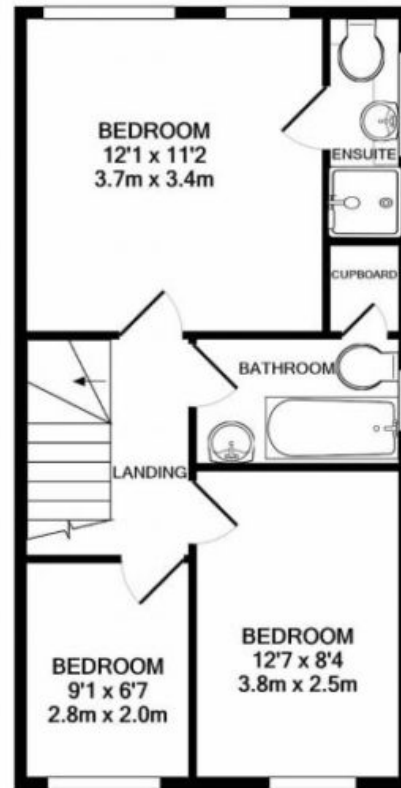

1ST FLOOR

Whilst every attempt has been made to ensure the accuracy of the floor plan contained here, measurements of doors, windows, rooms and any other items are approximate and no responsibility is taken for any error, omission, or mis-statement. This plan is for illustrative purposes only and should be used as such by any prospective purchaser. The services, systems and appliances shown have not been tested and no guarantee as to their operability or efficiency can be given  
Made with Metropix ©2019