

Call: +44 (0)1252 361550



Woollards Road, Ash Vale, Surrey, GU12 5DS

A truly exceptional four double bedroom semi detached family home which is located in this rarely available and highly sought after no through road in Ash Vale village. With a large driveway to the front with parking for several vehicles and a garage this home has so much to offer families. There are two generous reception rooms and a large conservatory downstairs with a modern kitchen and cloakroom. Upstairs there are four good sized double bedrooms and a modern family bathroom. To the rear is a beautiful south facing garden approximately 100ft in length. This road is unique because at the end is the entrance to Ash Ranges which are perfect for walking and outdoor pursuits and also just around the corner is the Wharf and the Basingstoke Canal. Ash Vale train station is also nearby as is the sought after Holly Lodge school. There is scope to extend and improve this brilliant home subject to the usual consents and we urge you to book in early to avoid missing out on this one off home.

Price: £465,000

Overview

- Four Double Bedrooms
- Semi Detached Family Home
- Two Reception Rooms
- Conservatory
- South Facing Rear Garden
- Driveway and Garage
- Scope for Extension (STPP)
- Convenient Location
- EPC: TBC
- Freehold

Call: +44 (0)1252 361550



Call: +44 (0)1252 361550

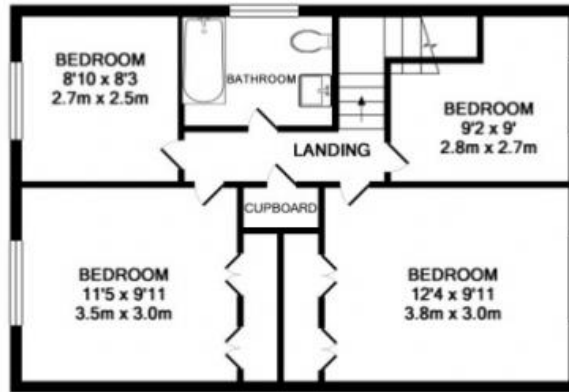

1ST FLOOR

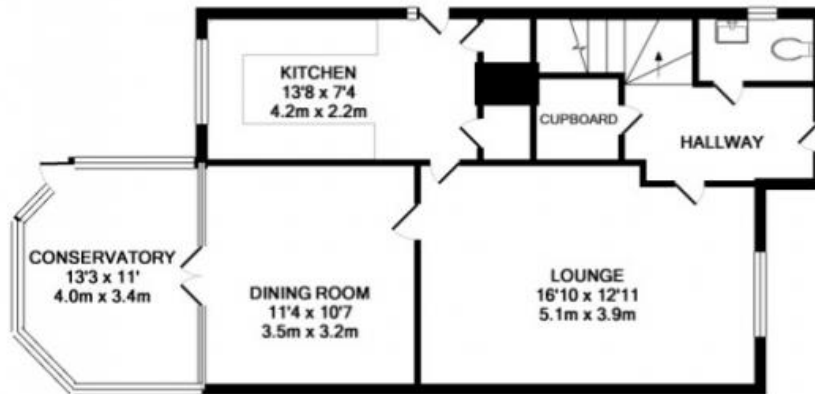

GROUND FLOOR

Whilst every attempt has been made to ensure the accuracy of the floor plan contained here, measurements of doors, windows, rooms and any other items are approximate and no responsibility is taken for any error, omission, or mis-statement. This plan is for illustrative purposes only and should be used as such by any prospective purchaser. The services, systems and appliances shown have not been tested and no guarantee as to their operability or efficiency can be given.
Made with Metropix 62019