



## Two Bedroom Apartment Ash Street, Ash, Surrey, GU12 6LH

price: £250,000

- Two Bedroom Apartment
- Sought After Location
- Close to Ash Strain Station
- Residents parking
- Open plan living
- Long lease
- Great Condition Throughout
- EPC: C (79)



## Description

Located within close walking distance of Ash train station and local amenities, this well proportioned two bedroom apartment offers excellent convenience and plenty of years remaining on the lease. The property features two double bedrooms, both with built-in wardrobes, a kitchen with ample cupboard and worktop space, a generously sized living/dining room and a family bathroom. The block is well maintained throughout and provides ample residents parking. The property must be viewed, so please do get in touch with us today to book your appointment.

## Outside

Outside, there are ample residents parking spaces, along with well kept communal grounds that wrap around the entire block.

To view the Material Information Certificate for this property please click [Here](#) or contact us to request a copy.

## Floorplan

### SECOND FLOOR

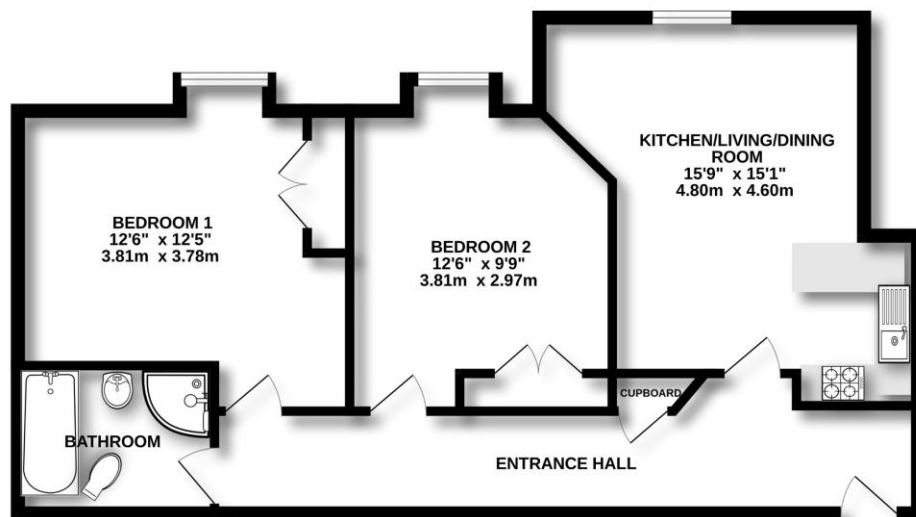

Measurements are approximate. Not to scale. Illustrative purposes only  
Made with Metropix ©2026



TO ARRANGE A VIEWING PLEASE CONTACT:  
Tel: **01252 361550** or Email: [info@bridges.co.uk](mailto:info@bridges.co.uk)



Important Notice - These particulars are set out as a general outline only for the guidance of intended purchasers/tenants and do not form part of any offer or contract and must not be relied upon as statements or representations of fact. Purchasers/Tenants must satisfy themselves by inspection or otherwise as to their correctness.